

Better Document Collaboration With **ADVANCED BOX**

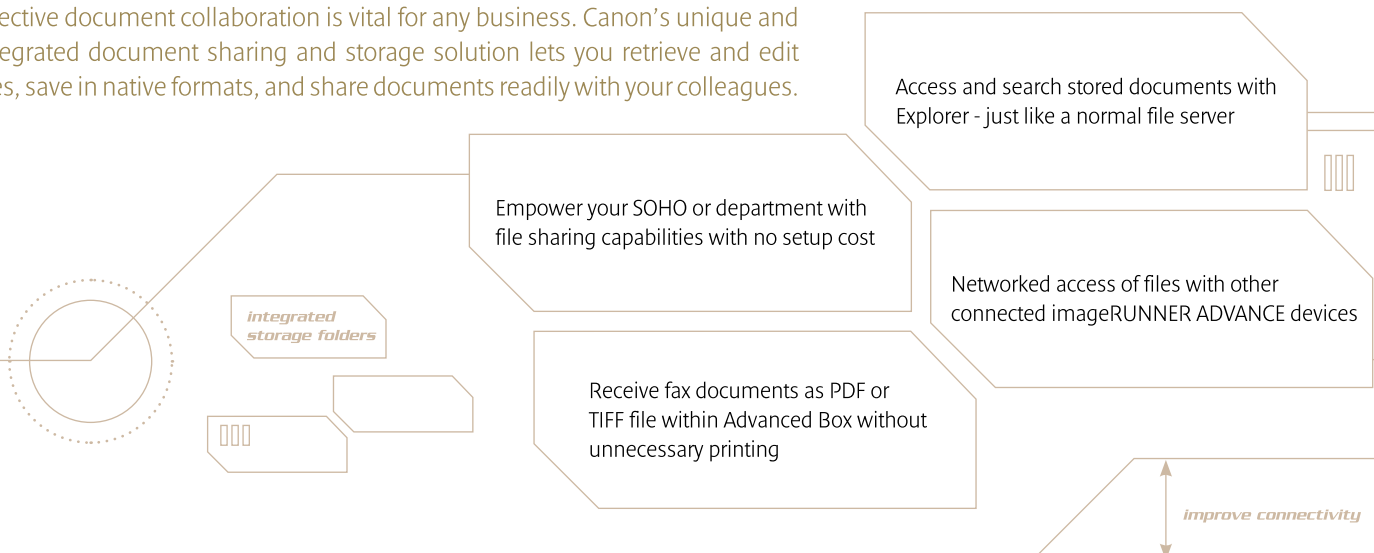

Simplify how your company collaborates with the Advanced Box.

Effective document collaboration is vital for any business. Canon's unique and integrated document sharing and storage solution lets you retrieve and edit files, save in native formats, and share documents readily with your colleagues.



Advanced made simple for you.

The next evolution in document collaboration

Advanced Box is an evolution to the device's Mail Box. It is a device resident storage feature that coexists with the Mail Box but serves an important new function as a built-in document sharing system. Advanced Box combines enhanced document management and collaboration (sharing) capabilities with external systems, and security/control features.

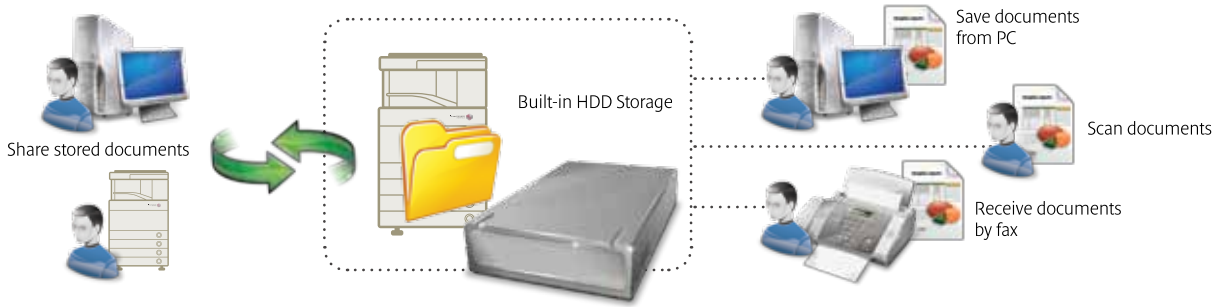

Fully integral solution for the PC environment

To effectively support the document collaboration capability, all file formats can be stored and accessed in its native format directly into Advanced Box fully from the PC environment. From the device, printable file formats (including JPG, TIFF, and PDF files) can be saved into and printed from local and remote locations, including imageRUNNER ADVANCE devices in the network.

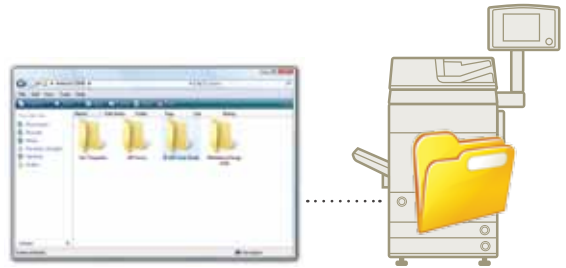

Share your documents publicly or privately

Advanced Box offers the flexibility to save files into two main folders, Shared and Personal (restricted) spaces. Personal folders restrict unauthorized access. For both Shared and Personal spaces, subfolders can be created, and up to 1,000 files/folders and subfolders can be saved in each level.

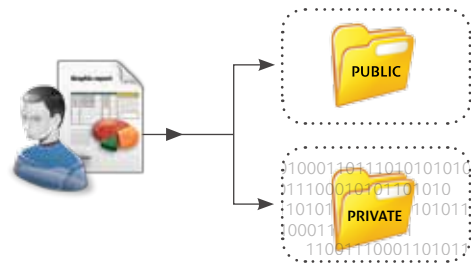

Two-tier Advanced Box HDD failsafe protection

HDD Mirroring

HDD mirroring deploys a second identical hard drive within the imageRUNNER ADVANCE device, which constantly keeps a synchronized backup image of the primary hard disk. In the unlikely event there is a failure of the primary HDD, the secondary drive will become primary and maintain device uptime until the primary is replaced.



HDD Backup

Allows users to backup folders/files stored in Advanced Box via SMB Server and data is encrypted to prevent data loss. Folder names, directory and access settings can also be saved using HDD Backup.



SOUTH & SOUTHEAST ASIA REGIONAL HEADQUARTERS

Canon Singapore Pte. Ltd.
1 HarbourFront Avenue #04-01, Keppel Bay Tower, Singapore 098632
Tel: +65-6799 8888 | Fax: +65-6799 8882 | www.canon-asia.com

To integrate these solutions into your imageRUNNER ADVANCE device, simply speak with your friendly Canon representative.

CANON SALES SUBSIDIARIES

India:
Canon India Private Limited
2nd Floor, Tower A & B
Cyber Greens, DLF Phase III
Gurgaon - 122002
Haryana, India
Tel: 91-124-516 0000
Fax: 91-124-516 0011
www.canon.co.in

Malaysia:
Canon Marketing (Malaysia) Sdn. Bhd
Block D, Peremba Square
Saujana Resort Section U2,
40150 Shah Alam
Selangor Darul Ehsan, Malaysia
Tel: 60-3-7844 6000 / 7845 0055
Fax: 60-3-7844 6196 / 6198
www.canon.com.my

Thailand:
Canon Marketing (Thailand) Co. Ltd
10th Floor Bangkok City Tower
179/34-45 South Sathorn Road
Bangkok 10120
Tel: 66-2-344 9999
Fax: 66-2-344 9960
www.canon.co.th

